



# DOUBLE BOLT PIPE CLAMP

## NEFCO FIG #N295

411 BURNHAM ST.  
 P.O. BOX 280186  
 EAST HARTFORD, CT 06108  
 TEL (860) 289-0285 FAX (860) 282-1487  
 TOLL FREE 1-800-969-0285

EMPIRE INDUSTRIES, INC. FIG. # 189  
 ERICO FIG. #452  
 TOLCO FIG. #5

**MATERIAL:**  CARBON STEEL

**FINISH:**  PLAIN  ELECTRO-GALVANIZED

**SERVICE:** DESIGNED FOR THE SUSPENSION OF INSULATED PIPE LINES. NORMALLY USED WITH WELDLESS EYE NUT, FIGURE #290.

**APPROVALS:** COMPLIES WITH FEDERAL SPECIFICATION WW-H-171-E (TYPE# 3), A-A-1192 A (TYPE# 3), AND MSS SP-58 AND SP-69 (TYPE# 3).

**ORDERING:** SPECIFY PIPE SIZE. FIGURE NUMBER AND FINISH.

**NOTES:** AVAILABLE IN 304 AND 316 STAINLESS STEEL.

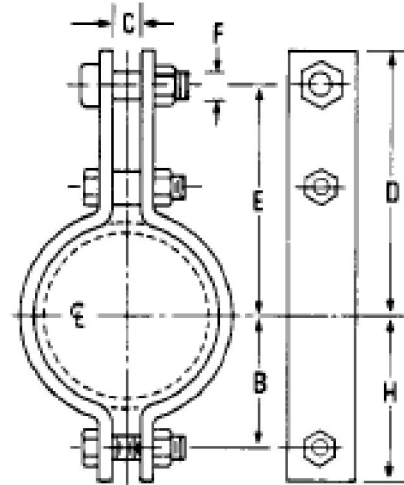

PIPE SIZE	PIPE OD	MATERIAL SIZE	F BOLT	B	C	D	E	H	WGT EACH (LBS)	MAX REC LOAD (LBS)
1/2	0.840	8ga x 1.00	3/8	1	5/8	2 7/8	2 5/16	1 9/16	0.540	950
3/4	1.050	8ga x 1.00	3/8	1 1/16	5/8	2 7/16	2 7/16	1 5/8	0.570	950
1	1.315	8ga x 1.00	3/8	1 3/8	5/8	2 5/8	2 5/8	1 15/16	0.605	950
1 1/4	1.660	8ga x 1.00	3/8	1 1/2	5/8	3 1/2	2 15/16	2 1/16	0.675	950
1 1/2	1.900	4ga x 1.250	5/8	1 15/16	7/8	4 11/16	3 13/16	2 13/16	1.715	1545
2	2.375	4ga x 1.250	5/8	2 3/16	7/8	5 9/16	4 11/16	3 1/16	1.925	1545
2 1/2	2.875	4ga x 1.250	5/8	2 7/16	7/8	6 7/16	5 9/16	3 5/16	2.115	1545
3	3.500	4ga x 1.250	5/8	2 3/4	1	7	6 1/8	3 5/8	2.260	1545
3 1/2	4.000	4ga x 1.250	5/8	2 7/8	1	7 1/4	6 3/8	3 3/4	2.365	1545
4	4.500	3/8 x 2	3/4	3 1/2	1 1/16	7 5/8	6 1/2	4 1/2	7.50	2500
5	5.563	3/8 x 2	3/4	4	1 1/16	8 1/8	7	5	8.13	2500
6	6.625	3/8 x 2 1/2	1	5	1 7/16	9 15/16	8 9/16	6 1/8	13.11	2865
8	8.625	3/8 x 2 1/2	1	6	1 7/16	10 15/16	9 9/16	7 1/8	14.67	2865
10	10.750	1/2 x 2 1/2	1	7 1/2	1 7/16	12	10 5/8	8 7/8	21.67	3240
12	12.750	1/2 x 2 1/2	1	8 1/2	1 7/16	13	11 5/8	9 7/8	23.83	3240
14	14.000	5/8 x 3	1 1/4	9 3/8	2	14 5/16	12 11/16	11	37.50	4300
16	16.000	5/8 x 3	1 1/4	10 3/8	2	15 5/16	13 11/16	12	41.00	4300
18	18.000	5/8 x 3	1 1/4	11 3/8	2	16 5/16	14 11/16	13	46.46	4300
20	20.000	3/4 x 3	1 1/2	12 3/4	2	17 1/2	15 7/8	14 3/8	60.00	5490
24	24.000	3/4 x 3	1 1/2	14 3/4	2	19 1/2	17 7/8	16 3/8	70.43	4500

### SUBMITTAL INFORMATION

CUSTOMER:		APPROVAL STAMP
PROJECT NAME:		
PROJECT NUMBER:	SECTION:	
PARAGRAPH:	OTHER:	