



Strut Channel Overview

Fasteners

Anchors

Strut

Threaded Rod

Pipe Hangers

Tools

Abrasives

On-Site Supplies

Safe

Strut - Channel Overview

PS 100 - 1-5/8" x 3-1/4" x 12 ga.
H-1200

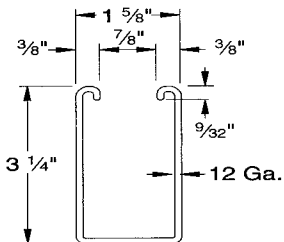

PS 100



PS 100 2T3

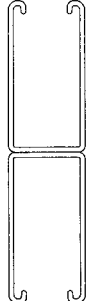

PS 150 - 1-5/8" x 2-7/16" x 12 ga.
E-1200

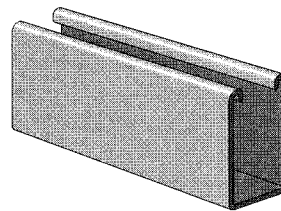

PS 150

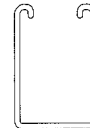

PS 150 2T3



PS 200- 1-5/8" x 1-5/8" x 12 ga.
A-1200

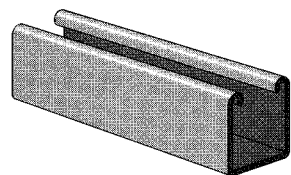

PS 200



PS 200 2T2

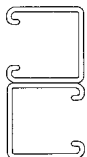

PS 200 2T3



PS 200 3T6

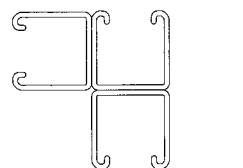

PS 200 2T4

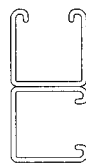

PS 200 2T5

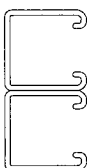

PS 200 2T5



PS 200 PLA

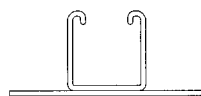

PS 200 PLB

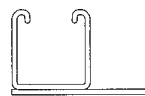

PS 210 - 1-5/8" x 1-5/8" x 14 ga.
A-1400

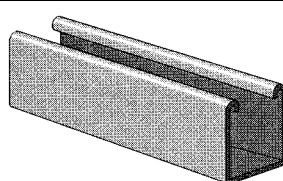

PS 210



PS 210 2T3



PS 300 - 1-5/8" x 1-3/8" x 12 ga.
C-1200

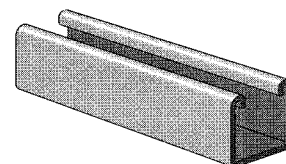

PS 300



PS 300 2T3

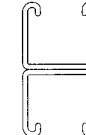

PS 500 - 1-5/8" x 13/16" x 14 ga.
B-1400

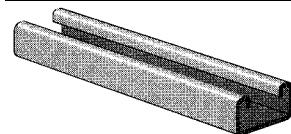

PS 500 2T5



PS 500 2T3



PS 400 - 1-5/8" x 1" x 12 ga.

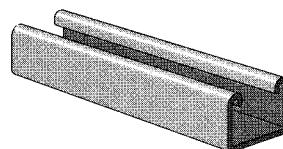

PS 400



PS 400 2T3



PS 520 - 1-5/8" x 13/16" x 12 ga.
B-1200

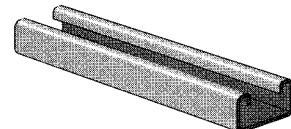

PS 520



PS 520 2T3



PS 560 - 1-5/8" x 13/16" x 16 ga.

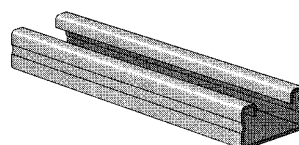

PS 560



PS 560 2T3



PS 5000 - 2" x 2" x 10 ga.

See Heavy-Duty Channel

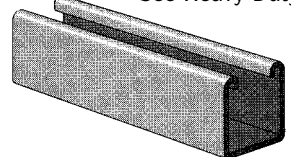

PS 600 J - 13/16" x 13/16" x 19 ga.

See Junior Channel

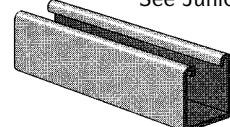

PS 700 J - 13/16" x 13/32" x 19 ga.

See Junior Channel

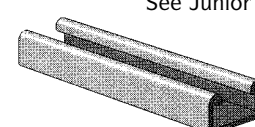



Strut - Channel Hole Pattern

Fasteners

Anchors

Strut

Threaded Rod

Pipe Hangers

Tools

Abrasives

On-Site Supplies

fety

Pierced Sections

Channel with Elongated Holes - "EH" Type - Power-Strut
"SH" Type - Superstrut

Stock

PS 100, PS 150, PS 200, PS 210, PS 200 2T3, PS 210, PS 300, PS 400, PS 500, PS 520, PS 560

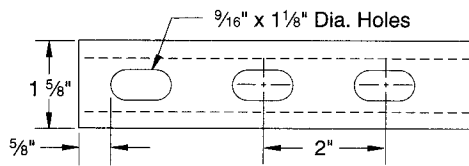
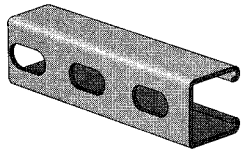

Channel with Holes - "H" Type - Power-Strut
"P" Type - Superstrut

PS 100, PS 150, PS 200, PS 210, PS 300, PS 400, PS 500, PS 520, PS 560

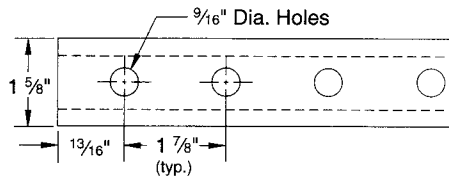
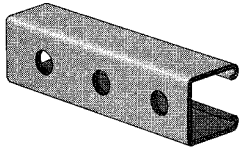

Channel with Holes - "H3" Type - Power-Strut Only

PS 200 only

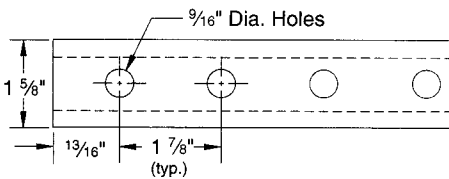
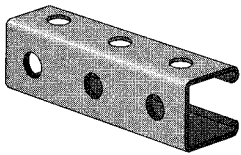

Channel with Slots - "S" Type - Power-Strut and Superstrut

PS 100, PS 150, PS 200, PS 210, PS 300, PS 400, PS 500, PS 520, PS 560

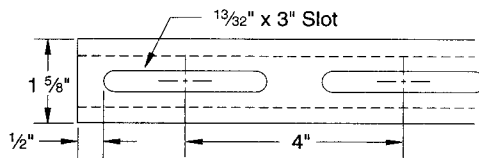
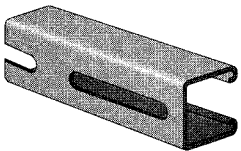

Channel with Knockouts - "KO" Type - Power-Strut and Superstrut

Stock

PS 100, PS 150, PS 200, PS 210, PS 300, PS 400

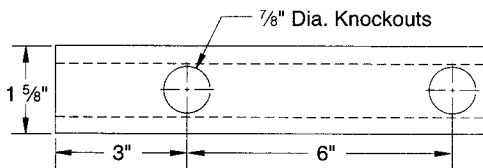
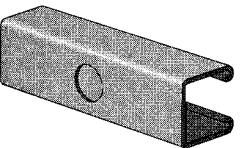

Channel with Slotted Back - "SB" Type - Power-Strut Only

PS 200 only

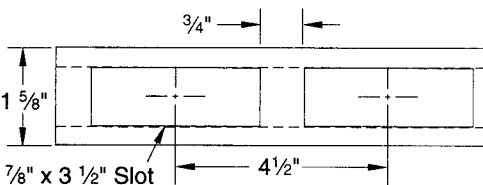
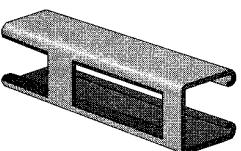



Strut - Channel

Fasteners

Anchors

Strut

Threaded Rod

Pipe Hangers

Tools

Abrasives

On-Site Supplies

Safe

"Deep" Strut

1-5/8" x 1-5/8" x 12 gauge

PS 200 (A-1200)

Ordering Note: Please specify PS 210 if you require 14 gauge 1-5/8" x 1-5/8" channel

Stock

- 10' Pre-Galvanized
- 20' Pre-Galvanized
- 10' Green
- 20' Green
- 10' Stainless Steel
- 20' Stainless Steel
- 10' HDG
- 20' HDG
- 20' Aluminum

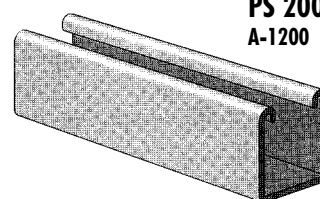
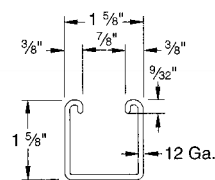

PS 200 - No Holes
A-1200

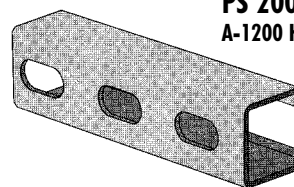

PS 200 EH - With Holes
A-1200 HS

	10' Solid	20' Solid	10' Slotted EH	20' Slotted EH
Plain	X	X	X	X
Pre-Galvanized	PS200EG10	PS200GE20	PS200HEG10	PS200HEG20
Green	PS200GR10	PS200GR20	PS200HEGR10	PS200HEGR20
Hot Dip Galv.	PS200HDG10	PS200HDG20	PS200EHHDG10	PS200EHHDG20
304 S/S	PS200SS10	PS200SS20	PS200EHSS10	PS200EHSS20
316 S/S	X	X	X	X
Aluminum	PS200AL10	PS200AL20	PS200EHAL10	PS200EHAL20
PVC Coated	PS200PVC10	PS200PVC20	PS200EHPVC10	PS200EHPVC20
Fiberglass	/AIC20P2000	N/A	/AIC20P2200	N/A

"Deep" Strut

1-5/8" x 1-5/8" x 14 gauge

PS 210 (A-1400)

"Shallow" Strut

1-5/8" x 13/16" x 14 gauge

PS 500 (B-1400)

Ordering Note: PS 500 14 gauge is standard. If you require 12 gauge, please specify PS 520 12 gauge.

Stock

- 10' Pre-Galvanized
- 20' Pre-Galvanized
- 10' Green
- 20' Green
- 10' Stainless Steel
- 20' Stainless Steel

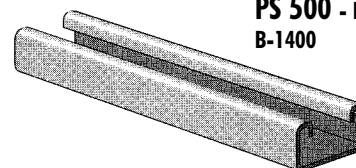
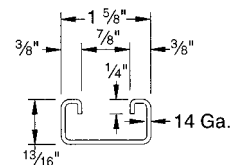

PS 500 - No Holes
B-1400

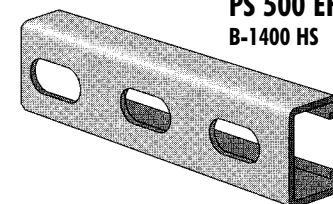

PS 500 EH - With Holes
B-1400 HS

	10' Solid	20' Solid	10' Slotted EH	20' Slotted EH
Plain	X	X	X	X
Pre-Galvanized	PS500EG10	PS500GE20	PS500EHG10	PS500EHG20
Green	PS500GR10	PS500GR20	PS500EHGR10	PS500EHGR20
Hot Dip Galv.	X	X	X	X
304 S/S	X	X	X	X
316 S/S	X	X	X	X
Aluminum	N/A	N/A	N/A	N/A
PVC Coated	X	X	X	X
Fiberglass	N/A	N/A	N/A	N/A

Threaded Rod and Studs

Ordering Note: Threaded rod in stock 6', 10' and 12' lengths. Studs cut to any length. Stocked in larger diameters. Call for availability over 1" diameter.

Size	Max. Load (lb)	Black 6'	E.G. 6'
1/4	240	25 C 600 Thread	25 C 600 Thread
3/8	730	37 C 600 Thread	37 C 600 Thread
1/2	1,350	50 C 600 Thread	50 C 600 Thread
5/8	2,160	62 C 600 Thread	62 C 600 Thread
3/4	3,230	75 C 600 Thread	75 C 600 Thread
7/8	4,480	87 C 600 Thread	87 C 600 Thread
1	5,900	100 C 600 Thread	100 C 600 Thread

Finishes

- Carbon steel plain and zinc plated
- Hot dip galvanized
- Stainless steel
- Type 304 and Type 316
- B7 (ASTM A193)
- Fiberglass

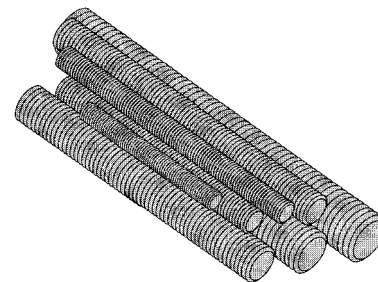



"Back to Back"

PS 200 2T3 (A-1202): 1-5/8" x 1-5/8" x 12 gauge welded channel

Stock:

- 10' Pre-Galvanized
- 20' Pre-Galvanized
- 10' Green
- 20' Green

	10' Solid	20' Solid	10' Slotted EH	20' Slotted EH
Plain	X	X	X	X
Pre-Galvanized	PS2002T3EG10	PS2002T3EG20	PS2002T3EHEG10	PS2002T3EHEG20
Green	PS2002T3GR10	PS2002T3GR20	PS2002T3EHGR10	PS2002T3EHGR20
Hot Dip Galv.	PS2002T3HDG10	PS2002T3HDG10	X	X
304 S/S	X	X	X	X
316 S/S	X	X	X	X
Aluminum	N/A	N/A	N/A	N/A
PVC Coated	X	X	X	X
Fiberglass	N/A	N/A	N/A	N/A

PS 200 2T3 - No Holes
A-1202

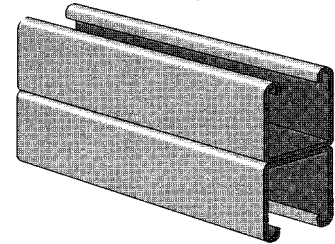

"Back to Back" with Holes

PS 200 2T3 (A-1202 HS): 1-5/8" x 1-5/8" x 12 gauge welded channel

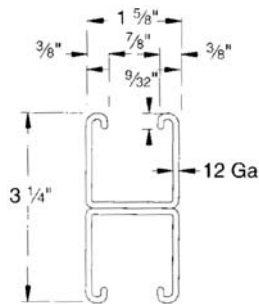
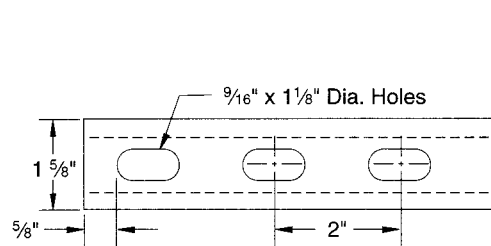

PS 200 2T3 EH- With Holes
A-1202 HS

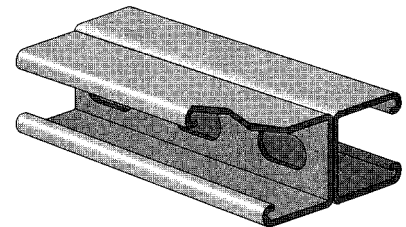

"2-7/16" Deep"

PS 150 (E-1200): 1-5/8" x 2-7/16" x 12 gauge

Stock:

- 10' Pre-Galvanized
- 20' Pre-Galvanized
- 10' Green
- 20' Green

	10' Solid	20' Solid	10' Slotted EH	20' Slotted EH
Plain	X	X	X	X
Pre-Galvanized	PS150EG10	PS150EG20	PS150EHEG10	PS150EHEG20
Green	PS150GR10	PS150GR20	PS150EHGR10	PS150EHGR20
Hot Dip Galv.	X	X	X	X
304 S/S	N/A	N/A	N/A	N/A
316 S/S	N/A	N/A	N/A	N/A
Aluminum	N/A	N/A	N/A	N/A
PVC Coated	X	X	X	X
Fiberglass	N/A	N/A	N/A	N/A

PS 150 - No Holes
E-1200

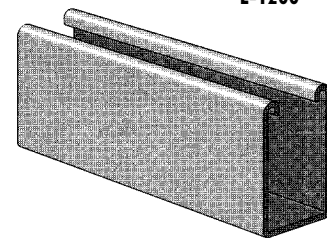

PS 150 - With Holes
E-1200 HS

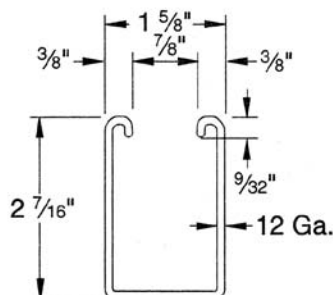
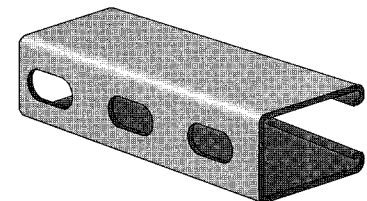



Slotted Angle

Fasteners

Anchors

Strut

Threaded Rod

Pipe Hangers

Tools

Abrasives

On-Site Supplies

Safe

"3-1/4" Deep"

PS 100 (H-1200): 1-5/8" x 3-1/4" x 12 gauge

Stock

- 10' Pre-Galvanized
- 20' Pre-Galvanized
- 10' Green
- 20' Green

	10' Solid	20' Solid	10' Slotted EH	20' Slotted EH
Plain	X	X	X	X
Pre-Galvanized	PS100EG10	PS100EG20	PS100EHEG10	PS100EHEG20
Green	PS100GR10	PS100GR20	PS100EHGR10	PS100EHGR20
Hot Dip Galv.	X	X	X	X
304 S/S	N/A	N/A	N/A	N/A
316 S/S	N/A	N/A	N/A	N/A
Aluminum	N/A	N/A	N/A	N/A
PVC Coated	X	X	X	X
Fiberglass	N/A	N/A	N/A	N/A

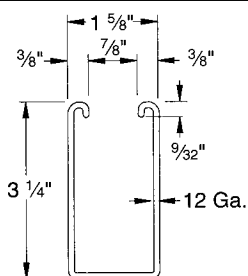

PS 100 - No Holes H-1200

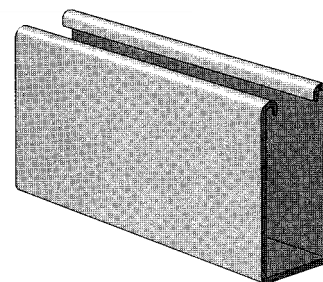

PS 100 - With Holes H-1200 HS

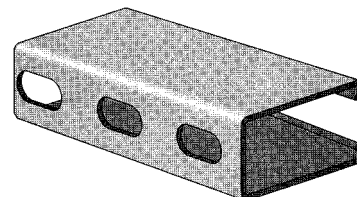

Knock-Out (KO)

PS 200 KO6 (A-1200 KO): 1-5/8" x 12 gauge with KO 6" on center

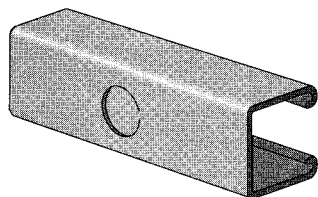

10' Pre-Galvanized
20' Pre-Galvanized

PS 707 (AB-844)

Raceway Closure Strip (Green and Pre-Galvanized)

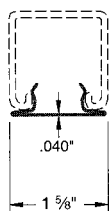
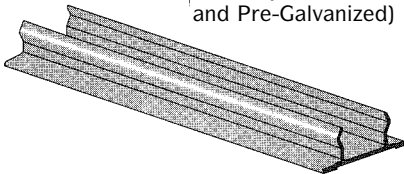

PS 6151 (AB-844 PC)

Plastic Closure Strip

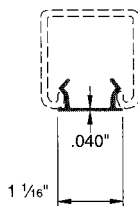
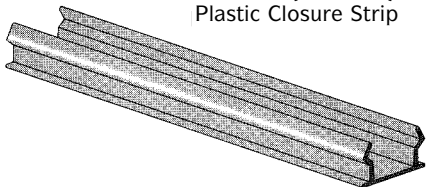

Slotted Angle

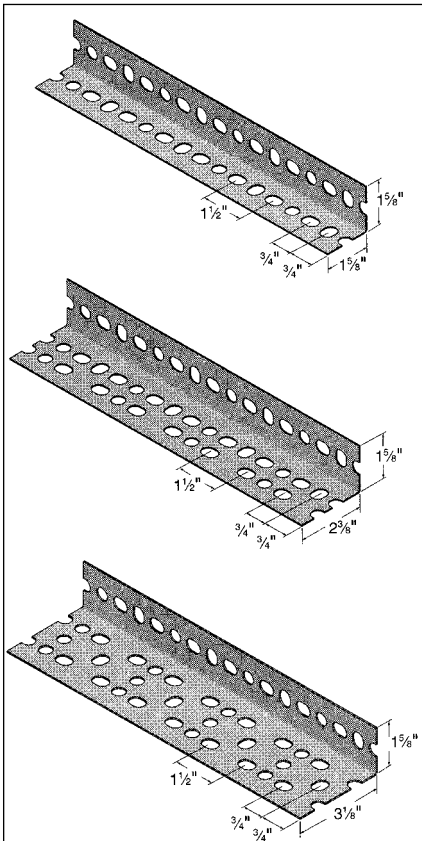

PA-158 Light Duty (RA-160)

1-5/8" x 1-5/8" x 14 gauge

10' Pre-Galvanized

PA-238 Medium Duty (RA-225)

1-5/8" x 2-3/8" x 14 gauge

10' Pre-Galvanized

PA-318 Heavy Duty (RA-300)

1-5/8" x 3-1/8" x 12 gauge

10' Pre-Galvanized



Raceway Concrete Insert Channel

Solid Raceway

Part No.	Section Height
PS 100	3-1/4
PS 150	2-7/16
PS 200	1-5/8
PS 210	1-5/8
PS 300	1-3/8
PS 400	1
PS 500	1-3/16

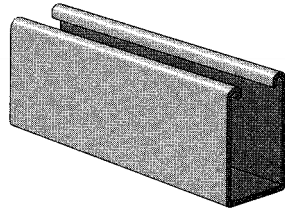

Knock-Out Raceway

Part No.	Section Height
PS 100 K06	3-1/4
PS 150 K06	2-7/16
PS 200 K06	1-5/8
PS 210 K06	1-5/8
PS 300 K06	1-3/8
PS 400 K06	1

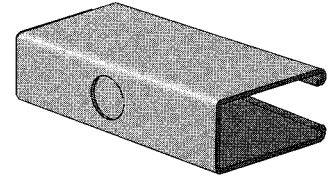

Slotted Support System

This system is designed for maximum ease of attaching fixture through slotted channel with shoulder bolt and provides positive alignment.

Note: Specify "S" Type Slotted Channel

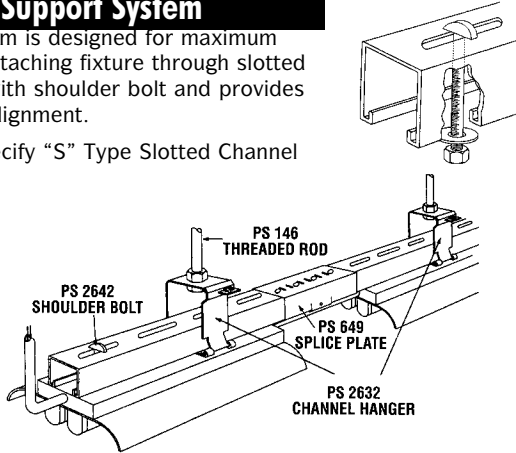

Note: Specify "S" Type Slotted Channel

Knockout Fluorescent Raceway System

Listed by Underwriter's Laboratories, Inc. Fixture is attached to slot-up channel with Chase nipple, locknut and bushing through knock-outs in bottom of channel. Conduit connector fitting PS-2561 holds channel and fixture to pipe or rod.

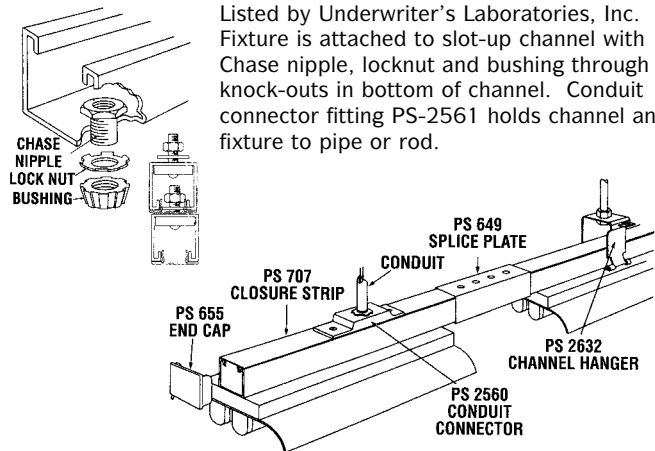

Concrete Inserts

PS 349 — Continuous Concrete Insert (1⁵/₈" x 1³/₈")

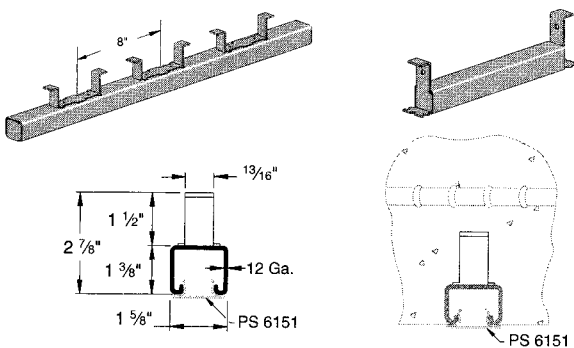

Choice of end cap is based on the distance from the end of the insert to the first anchor as shown below.

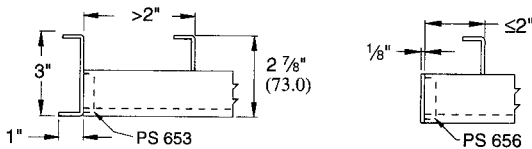

PS 656, PS 901 — Type 'A' End Cap

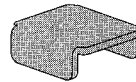

Use w/ Part No. Insert Finish Wt. per 100 pcs.

PS 656 PS 349 PGAL 8

PS 901 PS 449 PGAL 6

PS 654 — Type 'B' End Cap

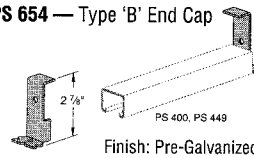

Finish: Pre-Galvanized

PS 6151 — Plastic Closure Strip

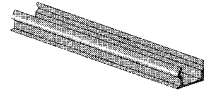

PS 707 — Raceway Closure Strip (Green and Pre-galvanized)

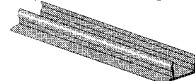

Junior Channel

PS 600J — Channel (1³/₁₆" x 1³/₁₆" x 19 ga.)

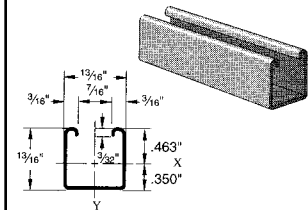

PS 700J — Channel (1³/₁₆" x 1³/₃₂" x 19 ga.)

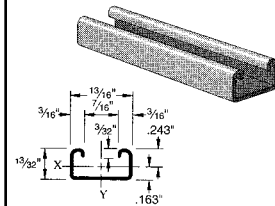

Note: A full line of fittings and accessories are available to fit junior size channel.

